

The United States of America:  
Peter Kwasny Inc.  
62-64 Enter Lane,  
Islandia, NY 11749

Distributed in

Canada by  
Peter Kwasny Spraypaint Canada Inc.  
2275 Lakeshore Blvd. West, Suite 530  
Toronto, ON. M8V 3Y3

Toll free North America  
Phone: 1-844-426-6330 / Fax: 1-866-226-6434  
order@kwasny.us / service@kwasny.us  
www.spraymax.com

**SprayMax®**  
**2K Wash Primer Olive Gray**  
**193 g NET WT. 6.8 oz**  
**Art. Nr. 3684029**



## Product

### Description / Purpose

2 component primer for fast insulation of sanded-through areas as part of car repair paintwork.

### Properties

- Very good adhesion
- Excellent anti-corrosion protection, in particular on aluminium
- Fast process times thanks to fine atomisation with minimum overspray
- Fast drying
- Can be topcoated with all standard 1K and 2K acrylic fillers

### Material base

Polyvinylbutyral/epoxy resins. Contains phosphoric acid. Free from zinc chromate and phenol.

### Colour

Olive Gray

### Gloss level

Matte

### Solid content

approx. 16 % by weight relating to the diluted paint

### EPA Coating Category

ABP Auto Body Primer

PWR Limit 1.55

### CARB Aerosol Rule Coating Category (01/2017)

TCC Two Component Coatings

PWR Limit 1.20

## Substrate

Steel (cleaned and sanded)

Galvanised steel (hot-galvanised, strip galvanised and electro-galvanised cleaned and sanded)

Aluminium, soft aluminium (cleaned and sanded)

Polyester surfaces (cleaned and sanded)

Old paint and factory paint (cleaned and sanded)

The damaged area must be dry and free of grease and dust and all rust needs to be removed.

## Processing

### Protection measures



Wear personal protection equipment.

(respiratory mask / gloves / goggles)

For more information, see safety data sheet.

### Shake

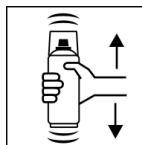

Before activating, shake can thoroughly for 2 minutes from when the mixing balls are heard.

### Place red button

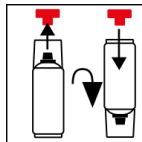

Remove the red button from the cap. Turn the can by 180° and fit the button onto the pin.

### Press red button

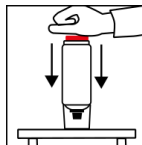

Turn the can upside down and place on a firm surface. Press the red button with the palm of your hand until it clicks into place.

### Shake

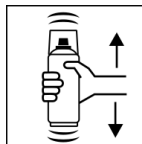

After activating, shake can again thoroughly for 2 minutes, again from when the mixing balls are heard.

### Spray to test

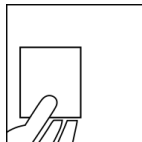

After shaking the can, test spray and check compatibility with the surface and the colour.

### Spraying distance

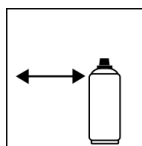

4 - 6 inches / 10 - 15 cm

**Spray passes**

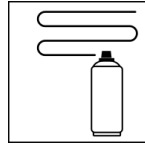

Dry film thickness 0.3 - 0.5 mil (8 - 12  $\mu\text{m}$ )  
(approx. 1 - 2 spray coats)

**Flash-off time**

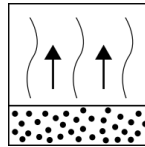

Flash time: approx. 5 min between each spray coat.

**Processing conditions**



Optimum application at 64° F - 77° F (18° C - 25° C)  
and a relative humidity from 40 - 50 %.

**Coverage**

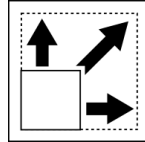

approx. 37 sq ft (3.5 m<sup>2</sup>) / aerosol at approx. 0.08 mil  
(2  $\mu\text{m}$ ) dry film thickness

**Drying**

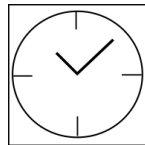

dust dry: 10 min

The stated values refer to the above-mentioned  
processing conditions. The level of dryness is  
determined pursuant to DIN 53150.

**Continue**

When dust-dry, it can be topcoated wet-on-wet with  
conventional 1K or 2K acrylic fillers.. In order to  
achieve the best possible corrosion protection, a flash  
time of 30 minutes (Reaction time on the metal  
surface) is recommended before further processing.  
If the Primer layer is not painted over within 8 hours,  
the surface should be cleaned with Silicone Remover.  
Can be topcoated after 20 - 30 min

**Pot life**

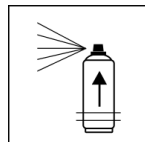

Approx. 96 h at 68° F (20° C) room temperature and  
a relative humidity of approx. 40 - 50 %.

The processing time depends on the ambient  
temperature. Higher temperatures reduce the pot life,  
lower temperatures will prolong it.

## Finish

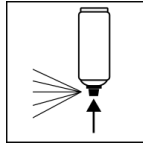

After painting, turn the can upside down and spray the valve until empty.

## Additional Information

### Important Information

Do not apply polyester and EP top coat products. Do not use on thermoplastic paintwork. Do not coat with water-based paints. Do not apply on plastic resin paint coats.

### Shelf Life

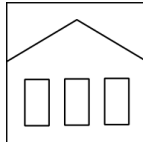

36 months (not activated)

The usage period refers to an unused can that is stored correctly at a temperature of 68° F / 20° C and a relative humidity below 60%. The can must be stored and transported in an upright position in a dry place where it is protected against chemical and mechanical influences. The safety information on the can and all statutory provisions applicable for the storage site must be observed.

### Disposal



The completely emptied spray cans must be disposed of in the recycling system. Cans with hardened material must be disposed of as special waste.

### Note

For professional use only.

Identification, see safety data sheet.

The contents in this technical data sheet were created with great care and reflect our current state of knowledge. They provide the user with application-specific information and do not promise certain properties. The information is non-binding and we accept no liability for its integrity, accuracy and completeness. They do not relieve the user of their duty to check the suitability of our product for the intended purpose. The warnings printed on our labels must be respected. Our brands and patents are protected by copyright. All rights reserved. We reserve the right to update, amend or supplement the content of the information without prior notice.